

# ESP ULR-T585MDL CORE INSTALLATION

Step 1. Install the empty lock housing or the lock shell into the empty hole you have prepared. Make sure to fasten it with the hex nut afterwards so the lock shell is firmly in place. The small ramp located inside the lock shell should be facing up.



Step 2. Insert one key into the lock core that came with the lock package. You will notice all the small pins are now flush except for the very last one. This last pin is called the retaining wafer. With a key inserted into the core, install the lock core into the empty shell with the retaining wafer facing up. You will be pushing down on that retaining wafer with the small ramp found on the inside of the lock shell. It helps if you come in at an angle.



Step 3. Once the retaining wafer is successfully pushed down with the help of the ramp located on the inside of the empty shell. The lock core will be slightly turned. It will look similar to the picture shown here. **DO NOT PUSH IN THE LOCK CORE ALL THE WAY AT THIS POINT!**



Step 4. Before inserting the lock core all the way into the lock housing. Hold the T-Bolt with one hand so that it sits flush at the bottom. If you do not do this. The back tail piece of the lock core cannot seat properly with the T-Bolt.

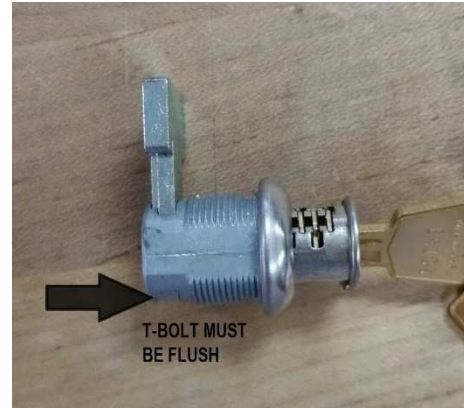

Step 5. You will know the core is successfully installed once the core is completely flush with the face of the lock. If for any reason you wish to remove the lock core. You will need to depress the retaining wafer through this top access hole.

